

HIK-CONNECT – OPENING AND CLOSING DOORS VIA THE ALARM

NOTE 1: TILE VIEW

This manual is presented in 'Tile View', if you are using the app in 'List View', you can change to 'Tile View' using this button.

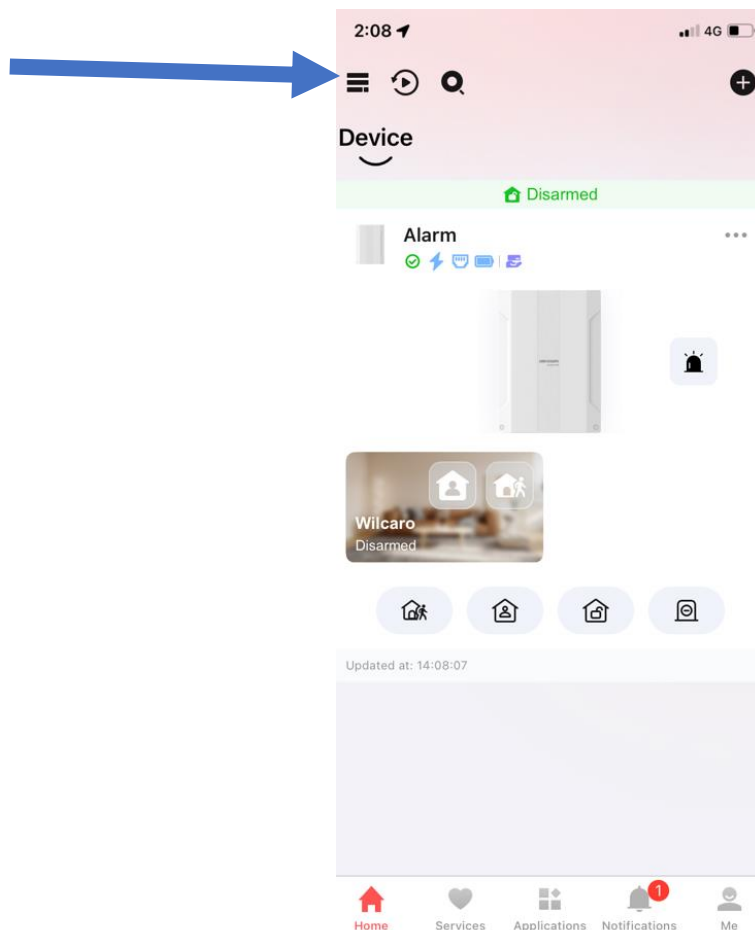

NOTE 2: REFRESH

Always 'drag the screen down and release' to refresh the page and get the latest status/information from the alarm panel.

PART 1: ENTER THE ALARM MENU BY CLICKING ON THE ALARM

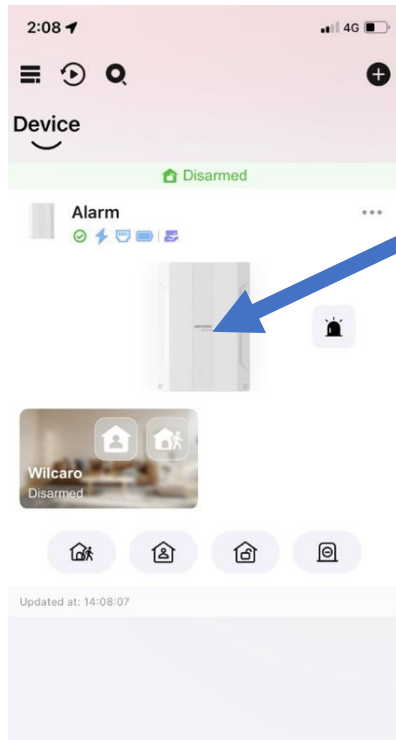

PART 2: GO TO THE DEVICE MENU

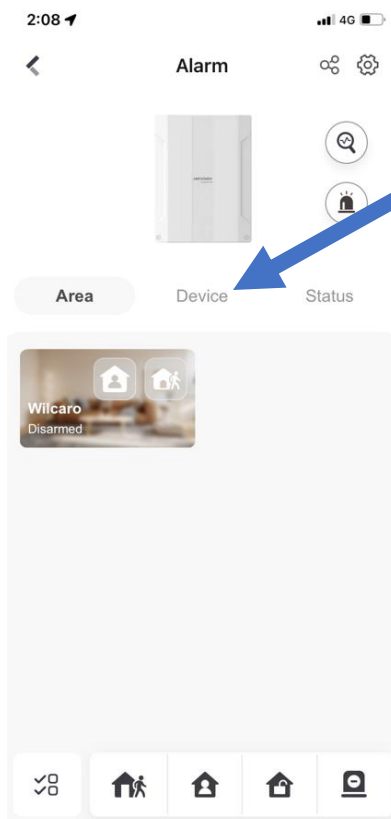

PART 3: YOUR DOOR/S MAY BE LISTED IN THE DEVICE MENU, USUALLY DOWN THE BOTTOM

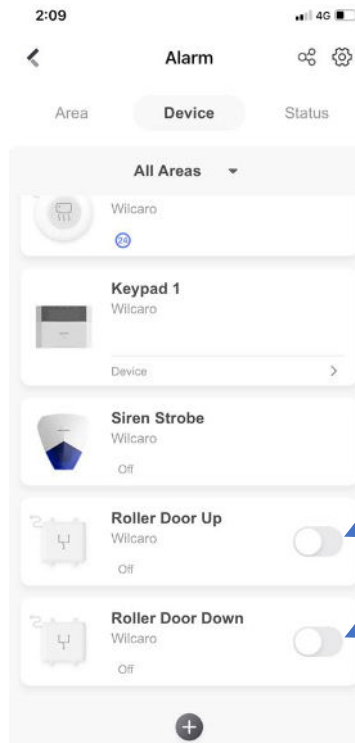

PART 4: THEY MAY ALSO BE IN A SUB-DEVICE MENU, SUCH AS IN A KEYPAD DEVICE MENU, OR AN EXPANDER MENU

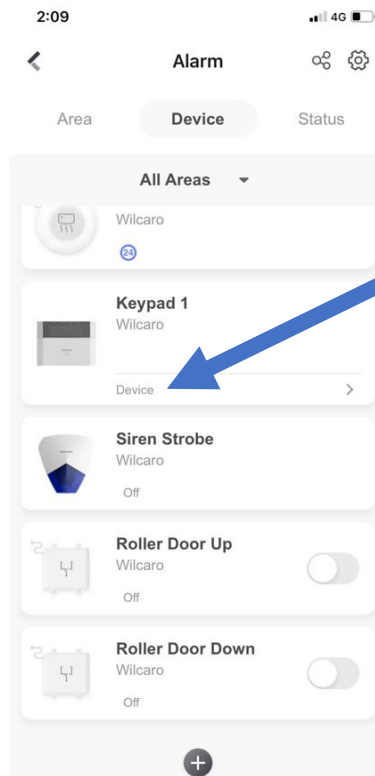

PART 5: THE SWITCH IN THE APP IS A TOGGLE SWITCH

1. Turning the toggle switch on once, then back off, is one activation.
2. This is the equivalent of pressing the button once on a remote/intercom/access control system.

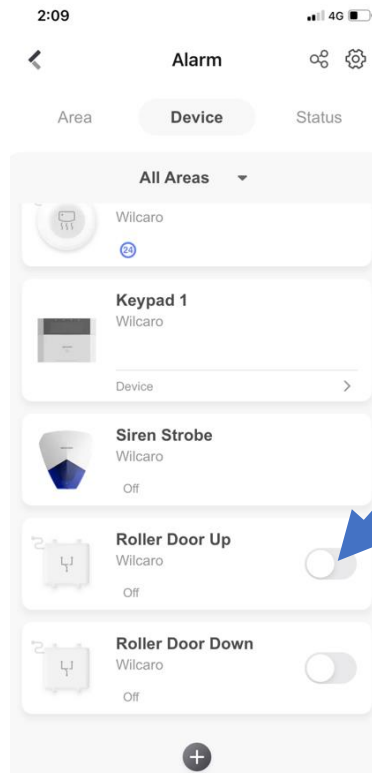

NOTE: BUTTON TYPE

Depending on your model of door (ie: roller door), the 'UP' and 'DOWN' buttons may be separate buttons, or they could be the same button.